

Series 12 Lollipop Bollard

GENERAL SPECIFICATIONS

Metal: All Series 12 Lollipop bollards are constructed of 1.9" (4.8cm) outside diameter steel pipe. The metal is powder coated with electrostatically applied polyester and baked at a high temperature to produce a mar-resistant finish.

Hardware: A special wrench for vandal resistant hardware is supplied with each bike rack. All hardware is professionally finished with our baked-on polyester powder coating.

INSTALLATION OPTIONS

The Series 12 Lollipop bollard is available as in-ground and bolt-down configurations.

In-ground: E12-BR01 installs directly into concrete to a depth of 12".

Bolt-down: E12-BR02 is fastened directly to the ground using 3/8" bolts (not provided). Vandal-resistant flush nuts are included for additional security.

METAL COLOURS

Choose from our 26 standard paint colours, or for an additional charge, choose from over 160 custom paint colours. Standard colour chips and custom colour charts are available upon request.

E12-BR01

13-7/8"
(35.2cm)

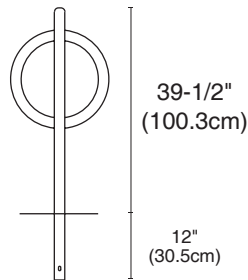

E12-BR02

13-7/8"
(35.2cm)

